

SGA-LW455A Suregrip A-LW Mig/Mag Torch Range

Rating: 400A CO₂, 340A mixed gas, EN60974-7 @ 60% duty cycle. 1.0 to 2.4mm wires

Air-Cooled Mig Welding Torch

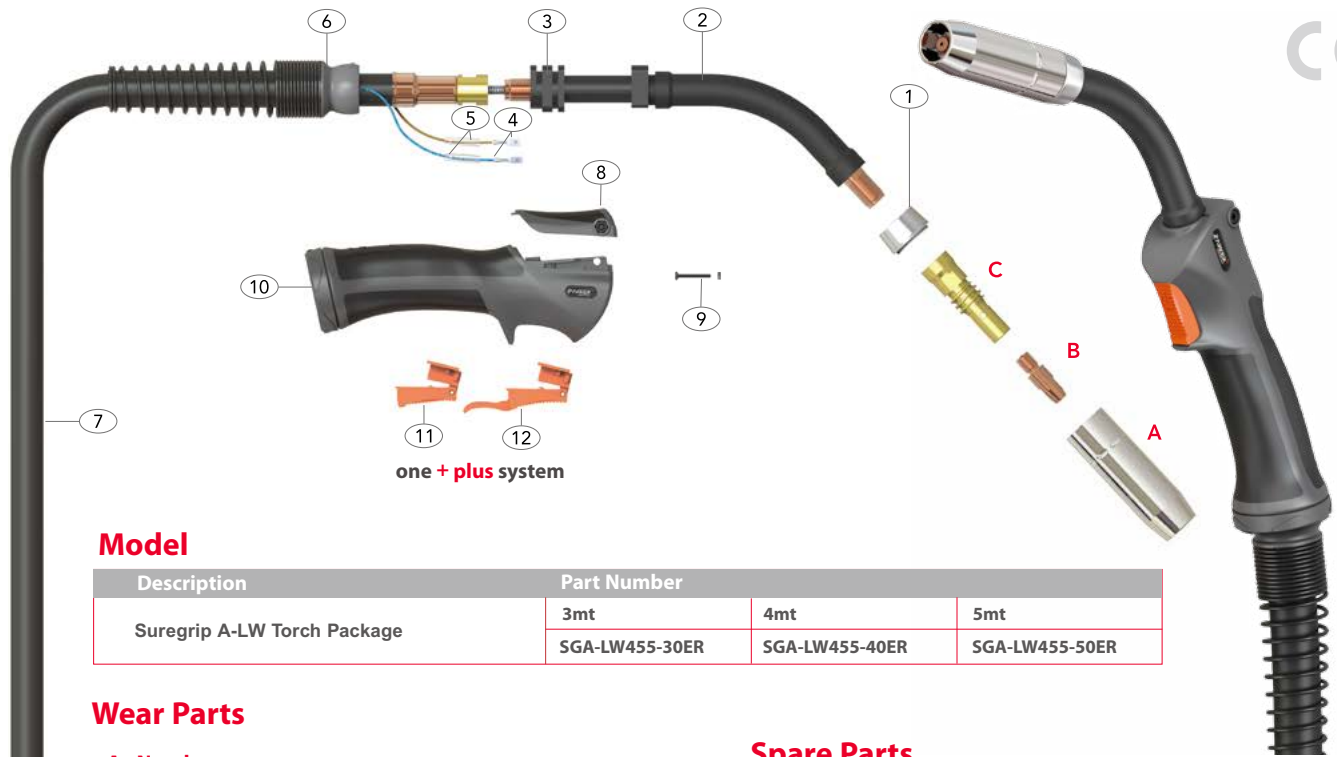

Model

Description	Part Number		
	3mt	4mt	5mt
Suregrip A-LW Torch Package	SGA-LW455-30ER	SGA-LW455-40ER	SGA-LW455-50ER

Wear Parts

A Nozzles

Part No.	Description	Bore	Length	Wall	Material
PA4527	Cylindrical Nozzle	24.0	83.0mm	2.0mm	Copper
*PA4528	Conical Nozzle	19.0	85.0mm	2.0mm	Copper
PA4529	Conical Nozzle	16.0	85.0mm	2.0mm	Copper

B Contact Tips

Part No.	Description	Material	Wire Size	Wire Size
			mm	inch
PB6015-10	Contact Tip	CuCrZr	1.0	0.040
*PB6015-12	Contact Tip	CuCrZr	1.2	0.045
PB6015-14	Contact Tip	CuCrZr	1.4	0.055
PB6015-16	Contact Tip	CuCrZr	1.6	0.063
PB6015-20	Contact Tip	CuCrZr	2.0	0.080
PB6015-24	Contact Tip	CuCrZr	2.4	0.095

C Tip Adaptors

Part No.	Description	Material
*PA4506	Tip Adaptor	Brass
PA4536	Tip Adaptor M8	Brass

D Liner

Part No.	Description	Length	Wire Size
			mm
*PB4531-30B	Steel Liner x 3mt	3.6mt	1.0-1.2
*PB4531-40B	Steel Liner x 4mt	4.6mt	1.0-1.2
*PB4531-50B	Steel Liner x 5mt	5.6mt	1.0-1.2

*Denotes torch package standard wear part set-up
For more information please refer to the following sections:
• Master Wear Parts Table Page 14-20
• Rear-End / Cable Parts Page 21-22

Spare Parts

Part Number	Description
1	PA4552 Adaptor Piece
2	PA4553 Swan Neck Assembly
3	PLW1515 Handle Location Body
4	PB1521 Cable Terminal
5	PB1521-C Cable Terminal Cover
6	PLW8018 Handle Cable Support c/w Ball Joint
7	PLW455-30 Cable Assembly x 3mt PLW455-40 Cable Assembly x 4mt PLW455-50 Cable Assembly x 5mt
8	PDM0 Top Housing With Grip
9	PDMNS Module Retaining Screw
10	PLW2515-KJ Handle Kit
11	DGBH2516M Trigger Assembly
12	DGBH2516LM Extended Trigger Assembly

